

Les Mondes de Diptyque

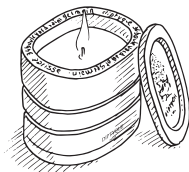

REFILLABLE SCENTED CANDLE

DIPTYQUE
PARIS

LES MONDES DE DIPTYQUE

THE WORLDS OF DIPTYQUE

You have just bought, or been given, a refillable Diptyque scented candle. Discover the special ritual for this candle, along with our recommendations for enjoying your candle to the fullest and prolonging your experience.

Les Mondes de Diptyque is a collection of candles like no other, a multi-volume saga that will transport you to a faraway place. In fragrant wisps, each candle tells the story of the place it embodies, a captivating confluence of nature and culture. Light a *Les Mondes de Diptyque* candle and step into a moment suspended in time, a dreamlike and stationary journey to lands unknown.

THE LES MONDES DE DIPTYQUE CANDLE RITUAL

Les Mondes de Diptyque extends an invitation to take part in a very special ritual:

Once the glass lid is removed and placed under the candle as a base, the scented wax is revealed and the olfactory journey may begin.

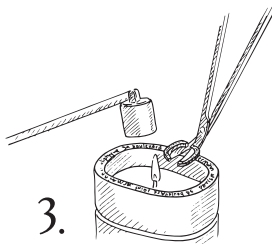
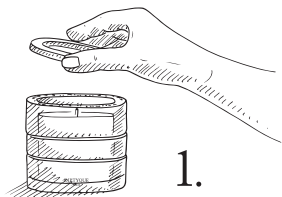

To start, light a match scented with the scent of the candle to release the fragrance.

At the end of your journey, use the candle snuffer to extinguish the flame, then trim the wick with the wick trimmer to prevent it from smoking and to preserve the candle's burn quality.

USING YOUR CANDLE: TIPS AND SAFETY PRECAUTIONS

Each candle in the *Les Mondes de Diptyque* collection is an exceptional product of French candle-making expertise, requiring particular care and attention.

USING THE CANDLE

To ensure the safety, quality and longevity of your scented candle, we recommend that you follow these guidelines:

- Place the lid beneath the candle to serve as a base and protect the surface on which the candle is placed.
- The first two times the candle is lit, let it burn for at least 5 hours each time until all the wax has become liquid on the surface. This will prevent the wax from hollowing out and forming a well around the wick.
- You may notice the candle smoking slightly when it is lit, as heat from the flame causes the liquid wax to rise up the wick.
- Use a candle snuffer to extinguish the candle. This will prevent the hot wax from splattering.
- To ensure that the candle burns evenly:
 1. Recentre the wick using the wick trimmer once the candle has been extinguished and while the wax is still liquid.
 2. Regularly trim the wick with the wick trimmer (ideal length: 3 to 5 mm) to avoid the candle smoking or overheating.
- If you notice any soot, gently wipe the sides of the candle jar, once it has cooled, with a damp cloth.
- When the candle is not in use, replace the lid to protect the wax.
- Do not relight the candle when less than 5 mm of wax remains or when the metal wick support is visible.
- Never leave a lit candle unattended.
- Do not place a burning candle in a draft, or in direct contact with a fragile or delicate surface.
- Never move a candle while it is lit or while the wax is still molten.
- Keep out of reach of children and pets, and away from curtains.
- Air out the room after burning a candle.

Sustainable luxury objects, *Les Mondes de Diptyque* candles were designed to last multiple lifetimes. With our range of eco-designed refills, refilling a *Les Mondes de Diptyque* candle couldn't be easier.

To clean and refill your candle jar, simply follow these steps:

CLEANING THE CANDLE JAR

1. The candle is finished when 5 mm of wax remains at the bottom, or when the metal wick support is visible.

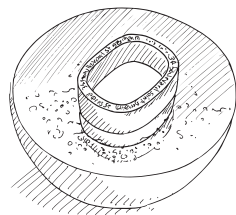
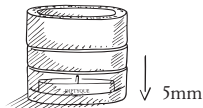

2. Let the candle cool completely to allow the wax to harden.

Place an empty heat-resistant bowl in the sink.

Place the candle jar inside the bowl. Pour 60°C water into the bowl until it reaches halfway up the height of the candle jar, taking care not to get any water inside the glass vessel.

3. Leave it to rest for 2 minutes. The heat of the water in which the glass vessel is soaking will melt the wax around the edges, making it easier to remove. Lift the glass jar out of the water, holding it by its top edge to avoid burning yourself.

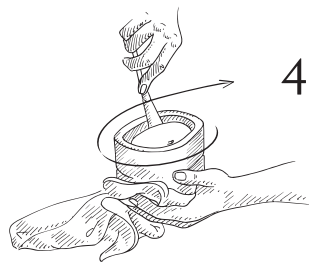

4. Use a blunt round-tipped knife to loosen the softened wax around the edges of the vessel. Gently pop out the wax and dispose in general waste.

Clean the vessel with a non-abrasive sponge or in the dishwasher and dry it thoroughly. Your *Les Mondes de Diptyque* candle jar is now ready to be refilled.

REFILLING THE CANDLE JAR

5. Remove the refill from its outer packaging.

Pull back the flaps on either side of the inner sleeve to open it, and gently remove the wax refill.

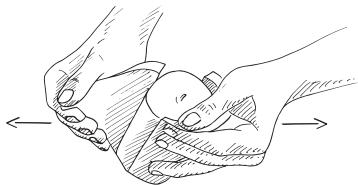

6. Place the wax refill into the glass vessel. A slight gap between the wax and the walls of the candle jar is perfectly normal.

Your *Les Mondes de Diptyque* candle is now ready for use.

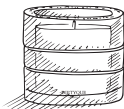



34 bd st germain 75005 paris
diptyqueparis.com